

SLIP-ON LOCK NUTS & W/ SQUARE WASHER

ZINC

CERTIFICATION

TECHNICAL DATA



FOR INSTALL SUPPORT
sales@allfasteners.com



FOR SPECIFICATION SUPPORT
certs@allfasteners.com



FOR CUSTOMER SUPPORT
888.859.6060



SLIP-ON LOCK NUTS & W/ SQUARE WASHER

ZINC

Slip-On Lock Nuts are specialized fasteners featuring two nuts stacked end-to-end. These can be slipped directly onto a threaded rod at any point, eliminating the need to spin them down the entire length. This innovative design enables quick assembly, reduces labor time, performs well in confined spaces, and provides vibration resistance.



Slip-On Lock Nuts with Square Washers are specialized fasteners featuring a nut and washer stacked end-to-end. These can be slipped directly on a threaded rod at any point, eliminating the need to spin them down the entire length. The integrated locking design enables fast installation and resists vibration, while the square washer distributes load evenly and prevents pull-through in oversized holes.



MATERIAL SPECIFICATIONS

- Zinc

TECHNICAL SPECIFICATIONS

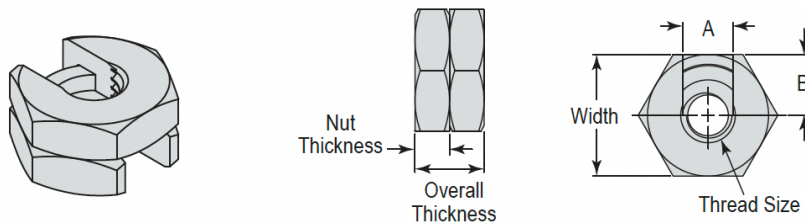

TABLE 1: TECHNICAL SPECIFICATIONS SLIP-ON LOCK NUT

PART #	THREAD SIZE (in.)	OVERALL THICKNESS (in.)	NUT THICKNESS (in.)	WIDTH (in.)	A (in.)	B (in.)	WEIGHT EACH (lbs.)	LOAD CAPACITY (lbs.)
2SLN3816	3/8-16	0.50"	0.25"	0.88"	0.37"	0.44"	0.06 lbs.	1000 lbs.
2SLN1213	1/2-13	0.63"	0.31"	1.05"	0.66"	0.51"	0.11 lbs.	1330 lbs.
2SLN5811	5/8-11	0.64"	0.31"	1.29"	0.66"	0.65"	0.18 lbs.	1650 lbs.

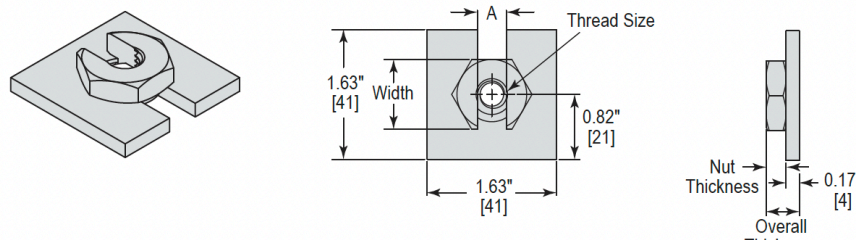

TABLE 1: TECHNICAL SPECIFICATIONS SLIP-ON LOCK NUT W/ SQUARE WASHER

PART #	THREAD SIZE (in.)	OVERALL THICKNESS (in.)	NUT THICKNESS (in.)	WIDTH (in.)	A (in.)	B (in.)	WEIGHT EACH (lbs.)	LOAD CAPACITY (lbs.)
2SLNW1420	1/4-20	0.35"	0.18"	0.64"	0.28"	0.44"	0.14 lbs.	240 lbs.
2SLNW3816	3/8-16	0.42"	0.25"	0.88"	0.37"	0.51"	0.15 lbs.	730 lbs.
2SLNW1213	1/2-13	0.48"	0.31"	1.05"	0.51"	0.65"	0.19 lbs.	1350 lbs.

**SLIP-ON LOCK NUTS & W/ SQUARE WASHER**
ZINC**ORDERING INFORMATION****TABLE 3: ORDERING INFORMATION SLIP-ON LOCK NUT**

PART NUMBER	ROD SIZE	FINISH	QTY/BOX
2SLN3816	3/8-16	Zinc	1
2SLN1213	1/2-13	Zinc	1
2SLN5811	5/8-11	Zinc	1

TABLE 4: ORDERING INFORMATION SLIP-ON LOCK NUT W/ SQUARE WASHER

PART NUMBER	ROD SIZE	FINISH	QTY/BOX
2SLNW1420	1/4-20	Zinc	1
2SLNW3816	3/8-16	Zinc	1
2SLNW1213	1/2-13	Zinc	1