

BEAM CLAMPS

C-CLAMP & JR TOP BEAM CLAMPS; PLAIN & ELECTRO-GALVANIZED

CERTIFICATION

TECHNICAL DATA

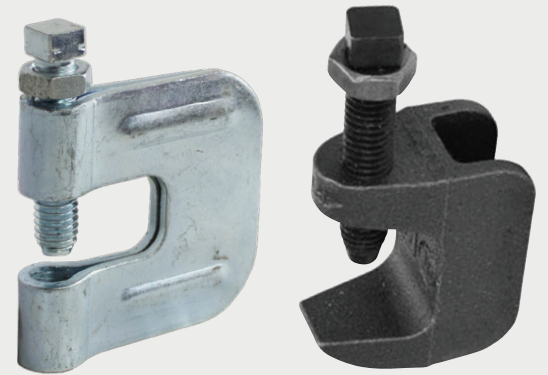

UL LISTED
on all sizes



FM APPROVED
on all sizes



FOR INSTALL SUPPORT
sales@allfasteners.com



FOR SPECIFICATION SUPPORT
certs@allfasteners.com



FOR CUSTOMER SUPPORT
888.859.6060



BEAM CLAMPS

C-CLAMP & JR TOP BEAM CLAMPS: PLAIN & ELECTRO-GALVANIZED

Beam Clamps provide a fast and efficient method for attaching threaded rod and support systems to structural steel beams without drilling or welding. Designed for use in mechanical, electrical, plumbing, and fire protection installations, beam clamps create secure attachment points for suspended pipe, conduit, cable tray, and equipment supports.

Available in Junior Top, Wide Mouth Top, and C-Clamp styles, beam clamps offer versatile solutions for a wide range of beam flange sizes and jobsite conditions.

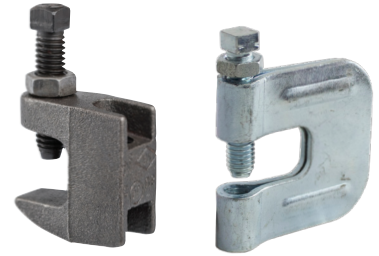

KEY BENEFITS

- UL® Listed
- FM Approved
- No drilling or welding required
- Fast and simple installation
- Secure attachment to structural steel
- Compatible with threaded rod suspension systems
- Available for a range of beam flange thicknesses
- Made of carbon steel (c-clamp) or malleable iron (jr top beam clamp)

APPLICATIONS

- Pipe hanger systems
- Mechanical equipment supports
- Electrical conduit installations
- Cable tray suspension
- Fire sprinkler piping
- HVAC support systems
- Industrial and commercial construction projects
- Structural steel attachment points for threaded rod systems

MATERIAL SPECIFICATIONS

TABLE 1: MATERIAL SPECIFICATIONS OF STEEL C-CLAMP BEAM CLAMPS

MATERIALS/FINISH	Plain Carbon Steel Electro-galvanized
VARIANTS	Plain Carbon Steel with Locknut Electro-galvanized with Locknut T-304 Stainless Steel with Locknut T-316 Stainless Steel with Locknut
SERVICE	Listed for the bottom flange of a beam. Features the ribbed design for added strength. Hardened steel cup point set screw secures clamp to beam.
APPROVALS	UL - U.L.C. listed 3/8 and 1/2 (1/2 for 4" IPS max) with locknut only. FM approved (excluding stainless steel) for 3/8 only with and without locknut. Complies with Federal Specification WW-H-171-E (Type# 23), A-A-1192 A (Type# 23), Manufacturers' Standard Society SP-58 and MSS SP-69 (Type# 23).
NOTES	See MSS SP-69 for proper set screw torque recommendations

**BEAM CLAMPS**

C-CLAMP & JR TOP BEAM CLAMPS: PLAIN & ELECTRO-GALVANIZED

MATERIAL SPECIFICATIONS**TABLE 2: MATERIAL SPECIFICATIONS OF JR TOP/BOTTOM BEAM CLAMPS**

MATERIALS/FINISH	Plain Malleable Iron: 3/8" - 7/8" Electro-Galvanized: 3/8" - 7/8" T-304 Stainless: 1/4" - 3/4" T-316 Stainless: 1/4" - 3/4"
VARIANTS	Plain Malleable Iron: 3/8" - 3/4" Electro-galvanized: 3/8" - 3/4"
SERVICE	Listed for top or bottom flange of a beam or bar joist where flange thickness does not exceed 5/8 of an inch.
APPROVALS	U.L. - U.L.C. listed 3/8 and 1/2 (1/2 for 4" IPS max). FM approved for 3/8 only. Complies with Federal Specification A-A-1192 A (Type# 19) and Manufacturers' Standardization Society MSS SP-58 and SP-69 (Type# 19).
NOTES	Set screw is of hardened steel. See MSS SP-69 for proper set screw recommendations. Stainless steel beam clamps are recommended for corrosive environments.

TABLE 3: MATERIAL SPECIFICATIONS OF WIDE MOUTH TOP/BOTTOM BEAM CLAMPS

MATERIALS/FINISH	Plain Malleable Iron Electro-Galvanized
VARIANTS	Plain Malleable Iron: 3/8" x 1/2" Electro-galvanized: 3/8" - 1/2"
SERVICE	Listed for top or bottom flange of a beam or bar.
APPROVALS	U.L. - U.L.C. listed 3/8" and 1/2" (1/2 for 4" IPS max). FM approved for 3/8" only. Complies with Federal Specification A-A-1192A (Type# 19) and Manufacturers' Standardization Society MSS SP-58 and SP-69 (Type# 19).
NOTES	See MSS SP-69 for proper set screw torque recommendations.

DIMENSIONAL DATA**TABLE 4: DIMENSIONAL DATA OF STEEL C-CLAMP BEAM CLAMPS**

ROD SIZE A	SET SCREW	C	D	E	F	MAX PIPE SIZE	WGT EACH (lbs.)		MAX REC LOAD (lbs.)
							PLAIN (W/O NUT)	PLAIN (W/ NUT)	
3/8-16	3/8-16	2-3/8	2-3/8	1	3/4	4	.38	.40	400
1/2-13	3/8-16	2-3/8	2-3/8	1	3/4	4	.38	.40	500
5/8-11	1/2-13	2-3/8	2-5/16	7/8	3/4	5	.56	.60	550
3/4-10	5/8-11	2-3/8	2-5/16	7/8	3/4	6	.60	.68	630
7/8-9	3/4-10	3	3-5/16	1-1/4	1-3/16	8	1.76	1.88	900

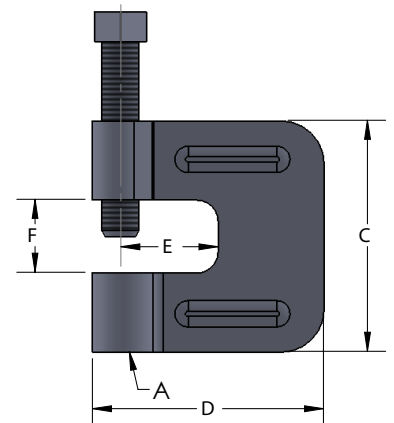



BEAM CLAMPS

C-CLAMP & JR TOP BEAM CLAMPS: PLAIN & ELECTRO-GALVANIZED

DIMENSIONAL DATA

TABLE 5: DIMENSIONAL DATA OF STEEL TOP/BOTTOM JR BEAM CLAMPS

ROD SIZE A	SET SCREW	B	C	D	E	F	MAX PIPE SIZE	WGT EACH (LBS.)	MAX REC LOAD TOP (lbs.)	MAX REC LOAD TOP (lbs.)
1/4-20	3/8-16	1-5/16	1-1/2	1/2	1	7/8	-	0.340	-	-
3/8-16	3/8-16	1-5/16	1-1/2	1/2	1	7/8	4	0.320	610	610
1/2-13	3/8-16	1-5/16	1-1/2	1/2	1	7/8	4	0.320	750	1130
5/8-11	3/8-16	1-3/4	1-3/4	5/8	1-3/8	1-1/8	5	0.580	750	1130
3/4-10	3/8-16	1-7/8	1-7/8	5/8	1-3/8	1-3/8	6	0.820	750	1130
7/8-9	1/2-13	2-3/8	1-7/8	5/8	1-3/8	1-3/8	8	0.795	750	1130

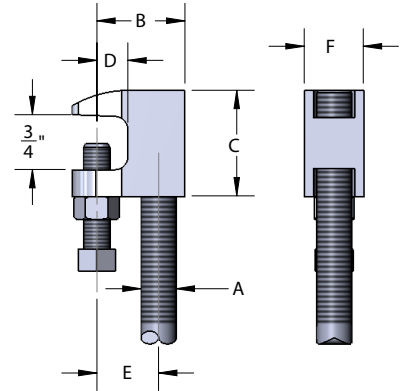
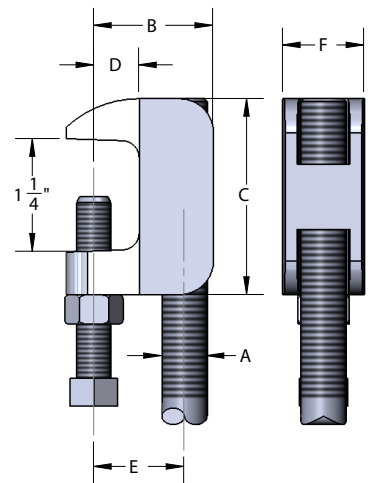

TABLE 6: DIMENSIONAL DATA OF STEEL WIDE MOUTH TOP/BOTTOM BEAM CLAMPS

ROD SIZE A	SET SCREW	B	C	D	E	F	MAX PIPE SIZE	WGT EACH (LBS.)	MAX REC LOAD TOP (lbs.)	MAX REC LOAD TOP (lbs.)
3/8-16	3/8-16	1-3/8	2	1/2	1	7/8	4	0.55	610	610
1/2-13	3/8-16	1-3/8	2	1/2	1	7/8	4	0.56	750	1130
5/8-11	3/8-16	1-7/8	2-3/8	5/8	1-3/8	1-1/4	5	0.66	750	1130
3/4-10	3/8-16	1-7/8	2-3/8	5/8	1-3/8	1-1/4	6	0.83	750	1130



ORDERING INFORMATION

TABLE 7: ORDERING INFORMATION OF STEEL C-CLAMP BEAM CLAMPS

PART NUMBER	ROD SIZE	FINISH	QTY/BOX
6CCPL038LN	3/8"	Plain	100
6CCGV038LN	3/8"	Electro-Galvanized	100
6CCGV012LN	1/2"	Electro-Galvanized	50
6CCGV058LN	5/8"	Electro-Galvanized	50
6CCGV034LN	3/4"	Electro-Galvanized	50

**BEAM CLAMPS**

C-CLAMP & JR TOP BEAM CLAMPS: PLAIN & ELECTRO-GALVANIZED

ORDERING INFORMATION**TABLE 8: ORDERING INFORMATION OF TOP/BOTTOM JR BEAM CLAMPS**

PART NUMBER	ROD SIZE	FINISH	QTY/BOX
6JBPL038	3/8"	Plain	100
6JBPL012	1/2"	Plain	100
6JBGV038	3/8"	Electro-Galvanized	100
6JBGV012	1/2"	Electro-Galvanized	100
6JBGV058	5/8"	Electro-Galvanized	50
6JBGV034	3/4"	Electro-Galvanized	50
6JBGV078	7/8"	Electro-Galvanized	50

TABLE 9: ORDERING INFORMATION OF WIDE MOUTH TOP/BOTTOM BEAM CLAMPS

PART NUMBER	ROD SIZE	FINISH	QTY/BOX
6TBPL038	3/8"	Plain	100
6TBGV038	3/8"	Electro-Galvanized	100
6TBGV012	1/2"	Electro-Galvanized	50
6TBGV058	5/8"	Electro-Galvanized	50
6TBGV034	3/4"	Electro-Galvanized	50